

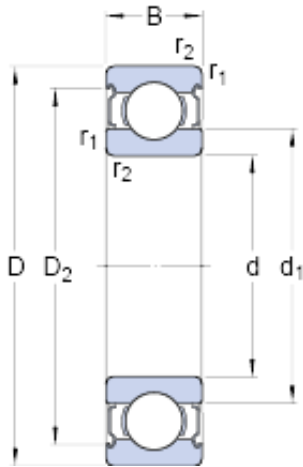

# Timken BEARINGS INDUSTRY



75 mm x 130 mm x 25 mm SKF 6215-2Z deep groove ball bearings

Bearing No. 6215-2Z

6215-2Z Bearing 2D drawings and 3D CAD models

|                                           |                          |
|-------------------------------------------|--------------------------|
| Size                                      | 130x75x25 mm             |
| Bore Diameter                             | 130 mm                   |
| Outer Diameter                            | 75 mm                    |
| Width                                     | 25 mm                    |
| d                                         | 75 mm                    |
| D                                         | 130 mm                   |
| B                                         | 25 mm                    |
| d <sub>1</sub>                            | 92.05 mm                 |
| D <sub>2</sub>                            | 116.5 mm                 |
| r <sub>1,2</sub> - min.                   | 1.5 mm                   |
| d <sub>a</sub> - min.                     | 84 mm                    |
| d <sub>a</sub> - max.                     | 92 mm                    |
| D <sub>a</sub> - max.                     | 121 mm                   |
| r <sub>a</sub> - max.                     | 1.5 mm                   |
| Basic dynamic load rating - C             | 68.9 kN                  |
| Basic static load rating - C <sub>0</sub> | 49 kN                    |
| Fatigue load limit - P <sub>u</sub>       | 2 kN                     |
| Reference speed                           | 10000 r/min              |
| Limiting speed                            | 5300 r/min               |
| Calculation factor - k <sub>r</sub>       | 0.025                    |
| Calculation factor - f <sub>0</sub>       | 14.7                     |
| Category                                  | Single Row Ball Bearings |
| Inventory                                 | 0.0                      |
| Manufacturer Name                         | SKF                      |



## Timken BEARINGS INDUSTRY

|                                 |                                                                                                                                                                          |
|---------------------------------|--------------------------------------------------------------------------------------------------------------------------------------------------------------------------|
| Minimum Buy Quantity            | N/A                                                                                                                                                                      |
| Weight / Kilogram               | 1.26                                                                                                                                                                     |
| EAN                             | 7316570902532                                                                                                                                                            |
| Product Group                   | B00308                                                                                                                                                                   |
| Enclosure                       | 2 Metal Shields                                                                                                                                                          |
| Precision Class                 | ABEC 1   ISO P0                                                                                                                                                          |
| Maximum Capacity / Filling Slot | No                                                                                                                                                                       |
| Rolling Element                 | Ball Bearing                                                                                                                                                             |
| Snap Ring                       | No                                                                                                                                                                       |
| Internal Special Features       | No                                                                                                                                                                       |
| Cage Material                   | Steel                                                                                                                                                                    |
| Internal Clearance              | C0-Medium                                                                                                                                                                |
| Inch - Metric                   | Metric                                                                                                                                                                   |
| Long Description                | 75MM Bore; 130MM Outside Diameter; 25MM Outer Race Diameter; 2 Metal Shields; Ball Bearing; ABEC 1   ISO P0; No Filling Slot; No Snap Ring; No Internal Special Features |
| Category                        | Single Row Ball Bearing                                                                                                                                                  |
| UNSPSC                          | 31171504                                                                                                                                                                 |
| Harmonized Tariff Code          | 8482.10.50.68                                                                                                                                                            |
| Noun                            | Bearing                                                                                                                                                                  |
| Keyword String                  | Ball                                                                                                                                                                     |
| Manufacturer URL                | <a href="http://www.skf.com">http://www.skf.com</a>                                                                                                                      |
| Manufacturer Item Number        | 6215-2Z                                                                                                                                                                  |
| Weight / LBS                    | 2.77                                                                                                                                                                     |
| Bore                            | 2.953 Inch   75 Millimeter                                                                                                                                               |
| Outside Diameter                | 5.118 Inch   130 Millimeter                                                                                                                                              |
| Outer Race Width                | 0.984 Inch   25 Millimeter                                                                                                                                               |
| d <sub>1</sub>                  | 92.05 mm                                                                                                                                                                 |
| D <sub>2</sub>                  | 116.5 mm                                                                                                                                                                 |
|                                 |                                                                                                                                                                          |



## Timken BEARINGS INDUSTRY

|                                |         |
|--------------------------------|---------|
| $r_{1,2}$ min.                 | 1.5 mm  |
| $d_a$ min.                     | 84 mm   |
| $d_a$ max.                     | 92 mm   |
| $D_a$ max.                     | 121 mm  |
| $r_a$ max.                     | 1.5 mm  |
| Basic dynamic load rating C    | 68.9 kN |
| Basic static load rating $C_0$ | 49 kN   |
| Fatigue load limit $P_u$       | 2.04 kN |
| Calculation factor $k_r$       | 0.025   |
| Calculation factor $f_0$       | 14.7    |
| Mass bearing                   | 1.23 kg |