

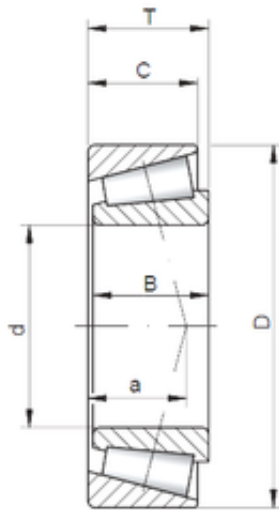

Timken BEARINGS INDUSTRY



65 mm x 105 mm x 23 mm ISO JLM710949/10 tapered roller bearings

Bearing No. JLM710949/10

Size	65x105x24 mm
Bore Diameter	65 mm
Outer Diameter	105 mm
Width	24 mm
d	65 mm
D	105 mm
T	24 mm
B	23 mm
C	18,5 mm
a	0,3 mm

JLM710949/10 Bearing 2D drawings and 3D CAD models