

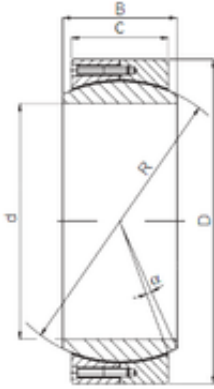

# Timken BEARINGS INDUSTRY

380 mm x 520 mm x 190 mm ISO GE 380 QCR  
plain bearings



Bearing No. GE 380 QCR

|                |                |
|----------------|----------------|
| Size           | 380x520x190 mm |
| Bore Diameter  | 380 mm         |
| Outer Diameter | 520 mm         |
| Width          | 190 mm         |
| d              | 380 mm         |
| D              | 520 mm         |
| B              | 190 mm         |
| C              | 160 mm         |
| R              | 450 mm         |
| Angle          | 4,1 °          |

GE 380 QCR Bearing 2D drawings and 3D CAD models